



# profiLINE 200

- max. Hub: 1740 mm
- Wiederholgenauigkeit: +/- 0,02 mm
- max. Belastung: 5000 N
- Spindelsteigung: 5, 10, 20 oder 25 mm
- max. stroke: 1740 mm
- repeat accuracy: +/- 0.02 mm
- max. load: 5000 N
- spindle pitch: 5, 10, 20 or 25 mm

profiLINE 200

Technische Zeichnung | technical drawing

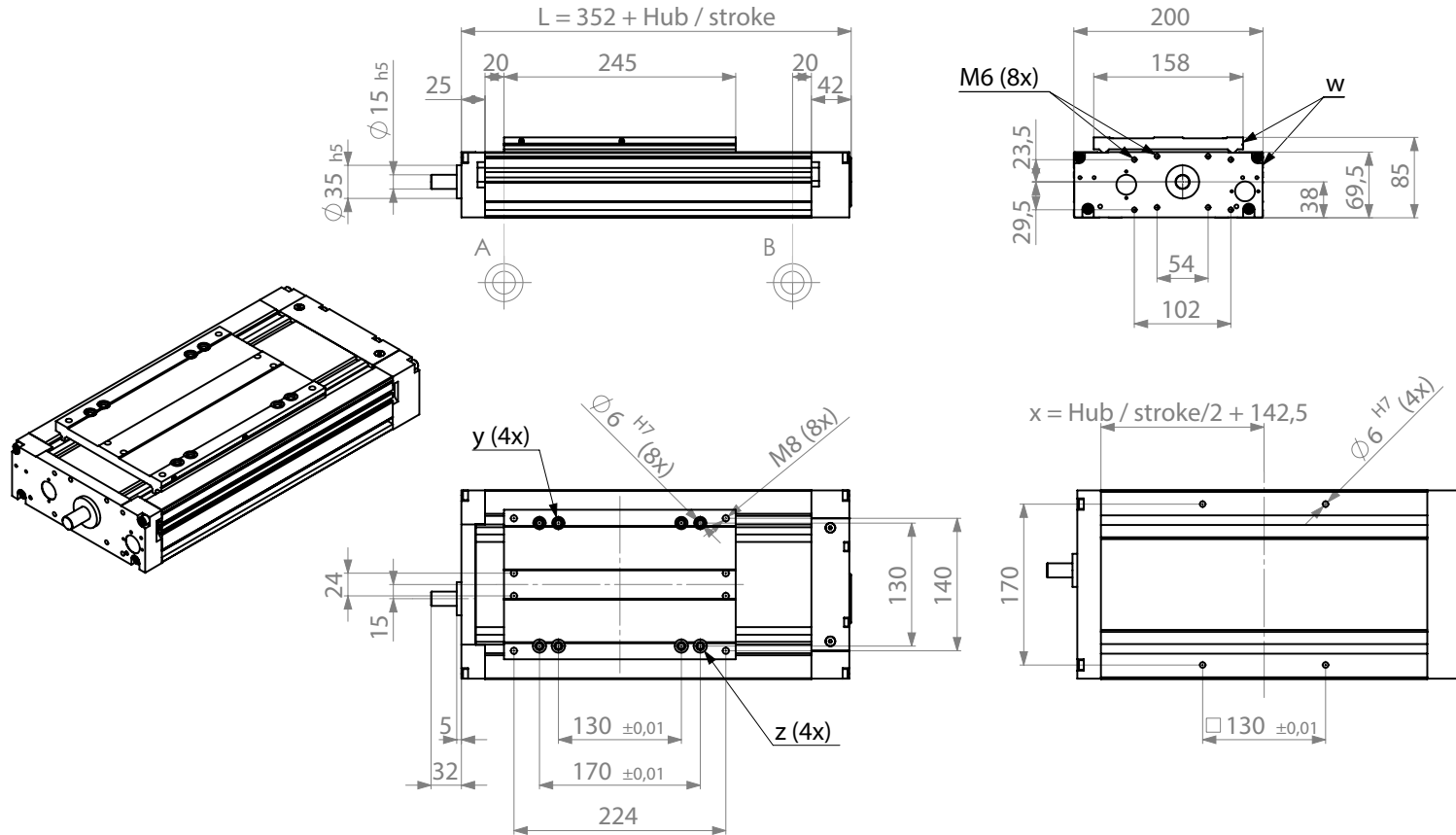

A; B = Hubbegrenzung Endschalter | A = Referenzpunkt standard | w = Referenzseiten Lineareinheit | y = Bundbohrbuchse DIN 172, A6x10 schwimmend gelagert | z = Festlager  
 A; B = stroke end limit switch | A = reference point standard | w = reference sides linear unit | y = headed drill bush DIN 172, A6x10 floating bearing | z = fixed bearing

## profiLINE 200

### Technische Daten | technical data

Hub (Hubabstufung 30 mm)	stroke (stroke increments 30 mm)	60 - 1740 mm
Temperaturbereich	temperature range	0 - 60 °C
Gewicht Grundschlitteneinheit (60 mm Hub)	weight basic slide unit (60 mm stroke)	13,4 kg
Gewichtszunahme (pro 60 mm Hub)	weight increase (per 60 mm stroke)	1,2 kg
Gewicht Schlitten (160 mm lang)	weight carriage (160 mm long)	4,1 kg
mögliche Spindelsteigung	possible spindle pitch	5/10/20/25 mm
Wiederholgenauigkeit	repeat accuracy	+/- 0,02 mm
Ablaufgenauigkeit (bei 500 mm Hub)	process accuracy (at 500 mm stroke)	≤ 0,04 mm
Spindelsteigungsfehler (bei 300 mm Hub)	spindle pitch error (at 300 mm stroke)	≤ 0,05 mm
Tragzahl Linearführungssystem dyn./stat.	load rating linear guide system dyn./stat.	89/152 kN
Flächenträgheitsmoment des Grundkörpers	geometrical moment of inertia of the basic body	$I_x$ 1.522.860 mm <sup>4</sup> / $I_y$ 19.324.203 mm <sup>4</sup>
Grundreibmoment	basic friction torque	0,45 Nm

$C_1$	5000 N
$C_2$	5000 N
$F_{axial}$	5000 N
$M_x$	600 Nm
$M_y$	600 Nm
$M_z$	600 Nm

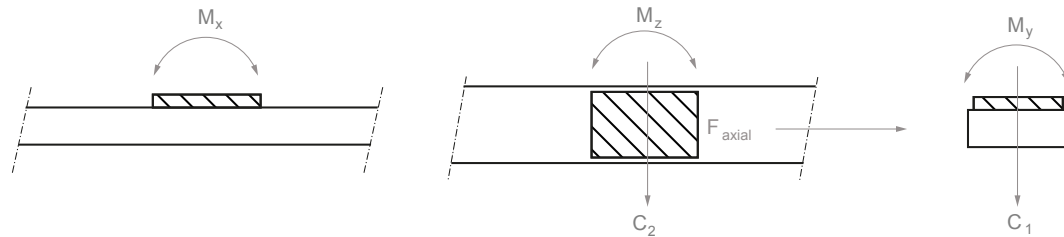

profiLINE 200 Zubehör | accessories

XY-Montage | XY-assembly

Montage Schlitten auf Schlitten  
assembly slide against slide

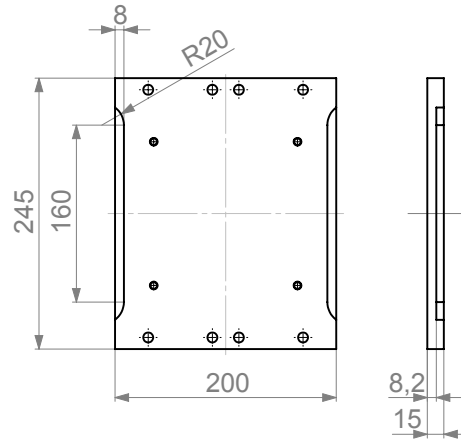
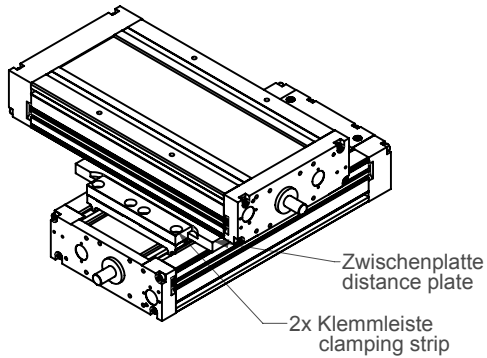

Zwischenplatte /distance plate Art.Nr. 1005893

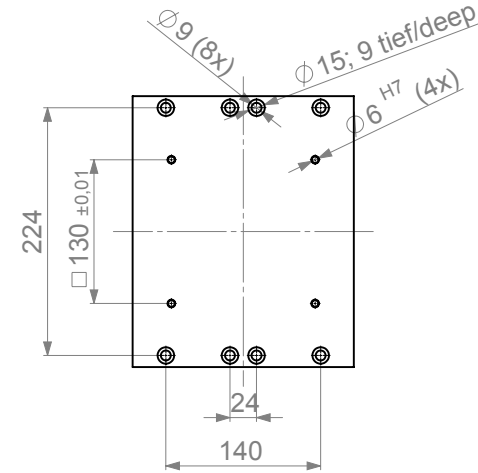

Montage Grundkörper auf Schlitten  
assembly basic carriage against slide

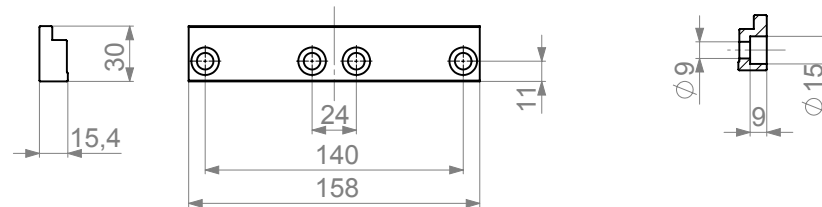
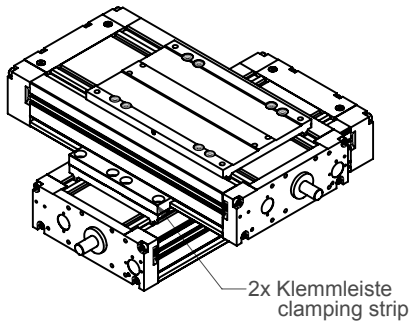

Klemmleiste /clamping strip Art.Nr. 1006097